

U.S. Department of Veterans Affairs
 White City, OR - Seismically Strengthened Wood Frame, Two-Story Hospital Building
 Building No: 201
 NSMP Station No: 7059

Revision Number: 10
 Revised on 02/14/2021
 Revised by: Ghahari/Celebi

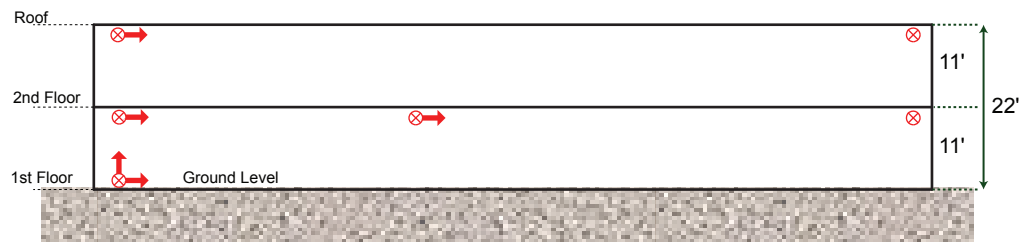

Elevation View Looking Reference West

The vertical to horizontal scale factor is 2

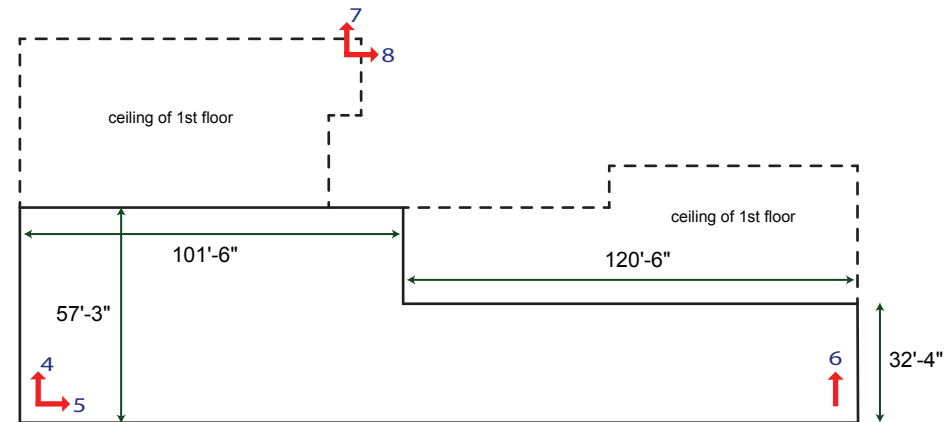

Second Floor

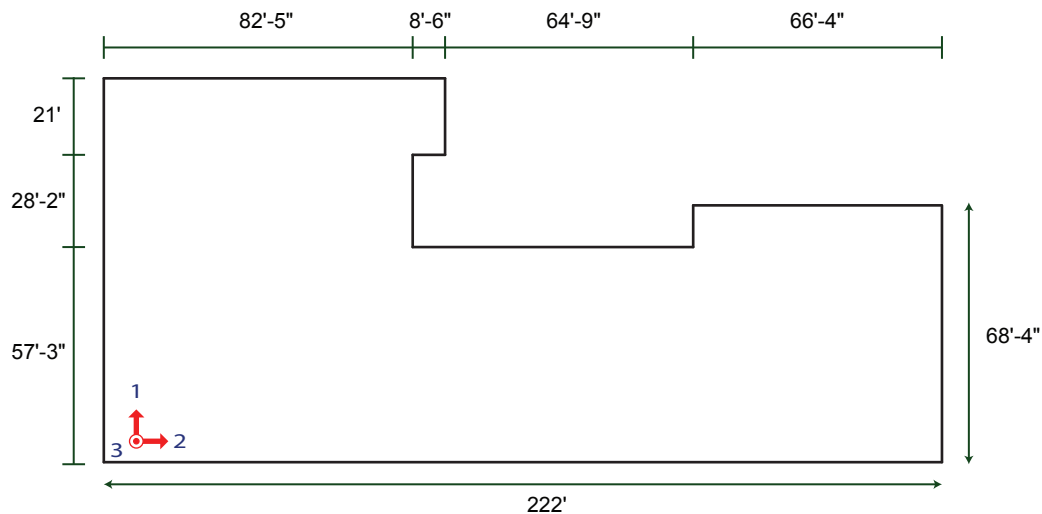

First Floor

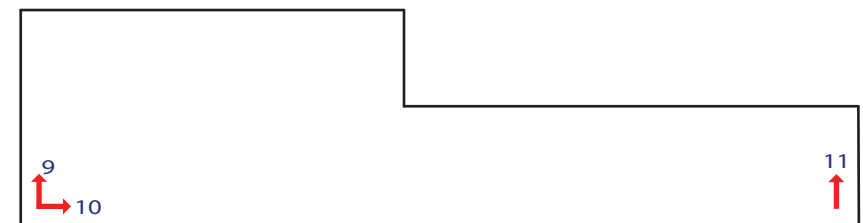
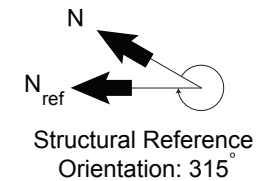

Roof